



FOR IMMEDIATE RELEASE

MAY 29, 2009  
CONTACT: RODNEY CAMPBELL  
PUBLIC INFORMATION OFFICER  
(520) 382-1936  
[WWW.MARANA.COM](http://WWW.MARANA.COM)

### NEW PARK CONSTRUCTION BEGINS JUNE 1

The Town of Marana on Monday will begin construction on the \$4 million Silverbell-Cortaro District Park. The park will be located at the southeast corner of Silverbell Road and Cortaro Road and is expected to be open by the end of 2009.

The park will have soccer and softball fields; basketball, tennis and volleyball courts; ramadas and restrooms; playgrounds; a dog park; an outdoor performance area; preserved cultural features; and pedestrian walkways and paths.

The Town and its contractor, D. L. Withers Construction Inc., want to ensure the safety of the public. Please stay clear of the construction area and be aware of construction signage, vehicles, and personnel. The construction will not significantly impact traffic at this time.

###

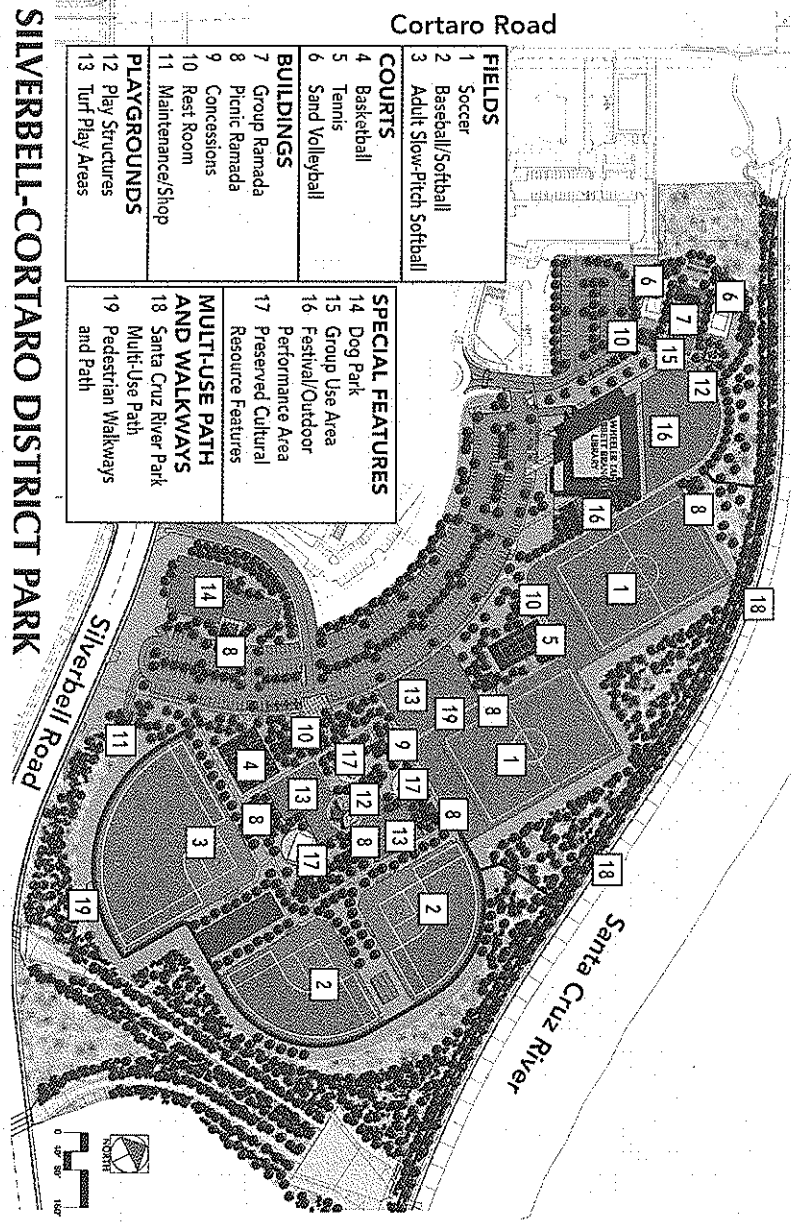

**SILVERBELL-CORTARO DISTRICT PARK**